

AIR-CONDITIONER REMOTE CONTROLLER INSTRUCTIONS

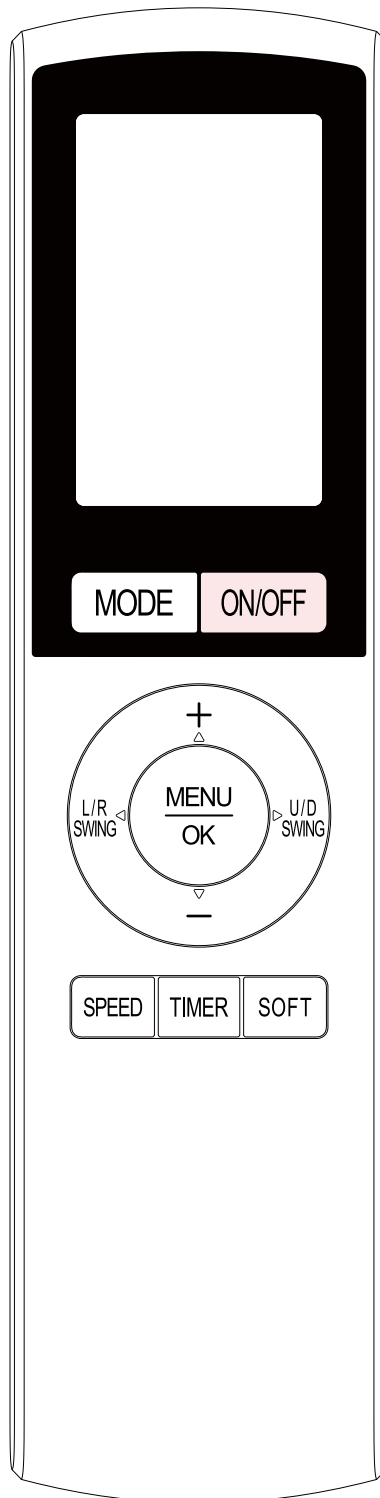

- Carefully read the instructions for safe and correct use of the air-conditioner.
- Carefully keep the instructions as it can be referred to at any time.

Precautions

- Before first time use of the remote controller, install the batteries and ensure the “+” and “-” poles are correctly positioned.
- Ensure the remote controller is pointed to the signal receiving window and that there is no obstruction between them, the distance is 8m at the maximum.
- Do not let the remote controller drop or fling it at will. Do not let any liquid in the remote controller. Do not expose the remote controller directly to the sunlight or excessive heat.
- If the remote controller does not function normally, remove the batteries for 30 seconds before reinstall them. If that doesn't work, replace the batteries.
- When replacing the batteries, do not mix the new batteries with old ones or mix batteries of different types, which could cause failure of the remote controller.
- If the remote controller is not to be used for a long period of time, remove the batteries first, lest the leakage from them may damage the remote controller.
- Properly dispose the discarded batteries.

Note:

- 1. This is an universal remote controller which provide all the function buttons. Please understand that some of the buttons may not function, depending on the specific air conditioner you have purchased. (If a specific function is not available on the air conditioner, pressing the corresponding button will simply have no respond.)**
- 2. HEAT and ELE.H functions are not available for single cool model.**

Buttons Description

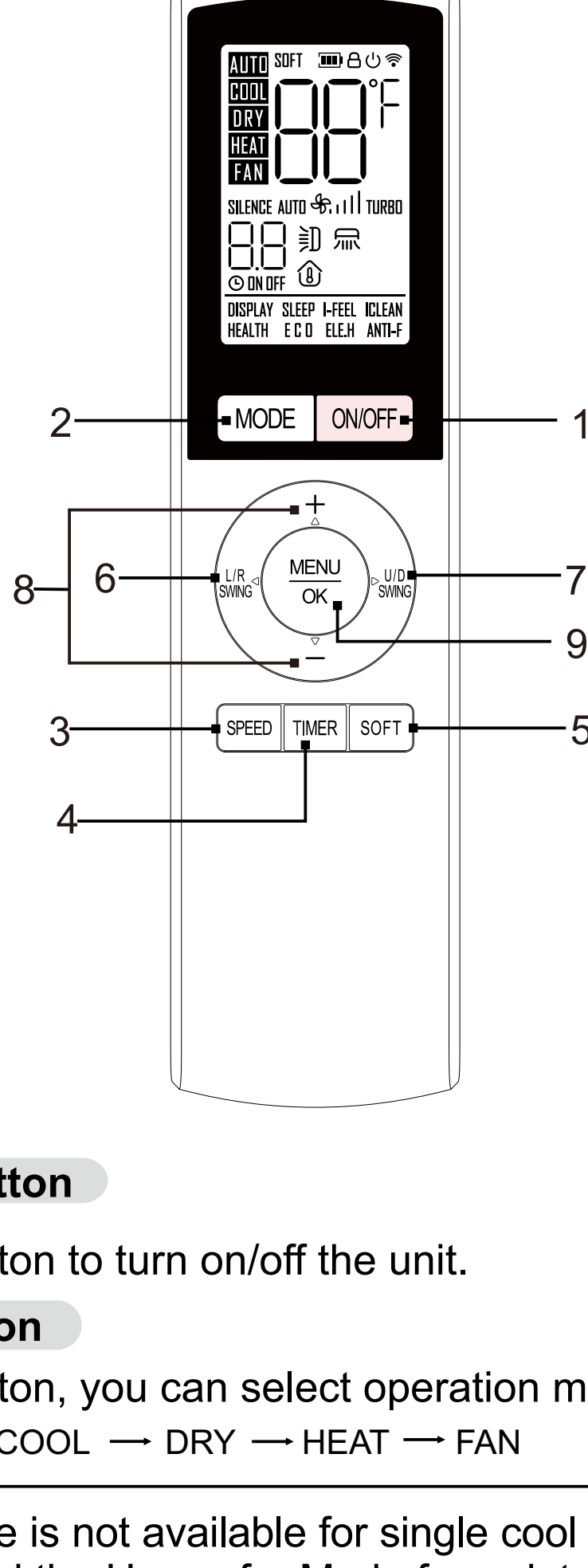

1. ON/OFF Button

- * Press this button to turn on/off the unit.

2. MODE Button

- * Press this button, you can select operation mode as follows:



- Note:** Heat mode is not available for single cool model. Please read the Usage for Mode for a detailed description.

3. SPEED Button

- * Press this button, you can select fan speed as follows:

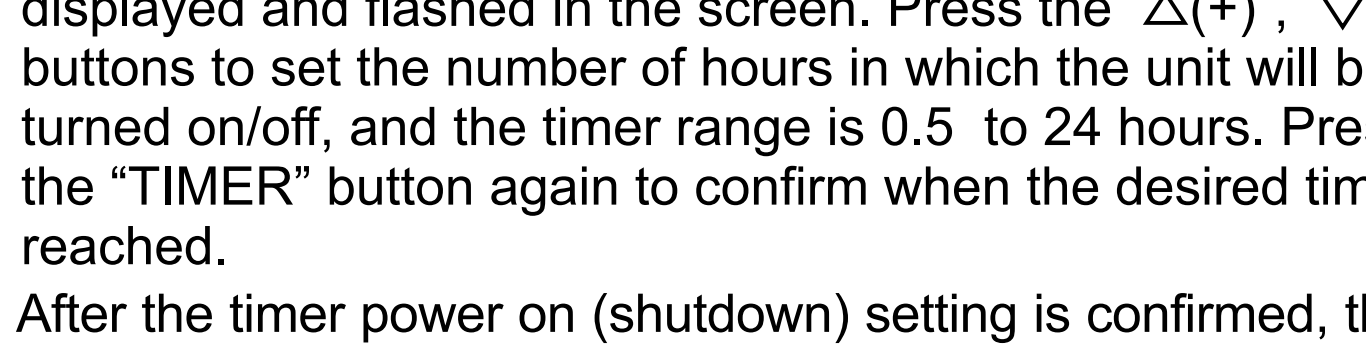

- Note:**
- * **Auto is not available in fan mode.**
- * **Turbo is not available in auto mode.**
- * **The SPEED button is forced low speed in dry mode.**

4. TIMER Button

- * When the air-conditioner is turned on (off), press this button will enter the timer function setting. Then "⌚" icon and "OFF (ON)" character will light up, and the timer time will be displayed and flashed in the screen. Press the "Δ(+)", "∇(-)" buttons to set the number of hours in which the unit will be turned on/off, and the timer range is 0.5 to 24 hours. Press the "TIMER" button again to confirm when the desired time is reached.
- * After the timer power on (shutdown) setting is confirmed, the "⌚" icon and "OFF (ON)" character will stop flashing and remain lighting. And the screen will display the corresponding mode, temperature, speed, swing, and all can be set by pressing the corresponding buttons.
- * After setting the timer power on (shutdown), if the timer time is not up, press the "ON/OFF" button to directly turn on (off) the unit and cancel the timer power on (shutdown).
- * If the "TIMER" button is not pressed within 10 seconds after the "ON (OFF)" start flashing, the timer setting will be exited.
- * If timer setting is confirmed, press "TIMER" button will cancel the timer function.

5. SOFT Button

- * The soft function can prevent people from being blown directly by cold air.
- * Only in the cool mode and the unit is on, press the "SOFT" button to turn on or off the soft function, and the screen will indicate or cancel the "SOFT" character.
- * After turning on soft function:
 - The up/down swing or the rated swing will turn off, and the screen will not display the swing icon.
 - Press any of the "SOFT" button, "OFF", "U/D SWING" or switch mode will cancel the soft function and the "SOFT" character.

6. L/R SWING Button

- * When the unit is on or the unit is shutdown but the timer is on, press this button to activate left/right swing and press it again to turn off the swing function, and the screen will indicate or cancel "↔" icon.

7. U/D SWING Button

- * When the unit is on or the unit is shutdown but the timer is on, press this button to activate up/down swing and press it again to turn off the swing function, and the screen will indicate or cancel "≡" icon.

- Note:**
- * Press the "U/D SWING" button and hold for 3 seconds, the button will shift to be the functional button of "Rated swinging", and then press the "U/D SWING" button to select the positions of Rated swinging.
- * Only by pressing the "U/D SWING" button again and hold for 3 seconds or reinstall the battery of the remote control could exit the "Rated swinging", and the icon of the rated swinging are disappeared, then the "U/D SWING" button resumes its original function.

8. + & - Button

- * Each time the "+" or "-" is pressed, the temperature setting will be increased or decreased by 1°C(1°F).
- * The temperature setting range: 16°C(60°F) ~ 32°C(90°F).

- Note: The temperature can not be set in auto or fan mode.**

9. MENU & OK Button

- * Press the "MENU" button to enter the function selection mode. Then press "Δ(+)", "∇(-)", "◀(L/R SWING)" and "▶(U/D SWING)" button to choose the function which you want. After, press the "OK" button, turn on this function.
- * In function selection mode, press "Δ(+)", "∇(-)", "◀(L/R SWING)" and "▶(U/D SWING)", the character in LCD will be flashing when the function be selected.

10. ECO function

- * When the unit is on and in the cool mode, press the "MENU" button, then press Δ(+), ∇(-), ◀(L/R SWING) and ▶(U/D SWING) to choose the "ECO" character, and the "ECO" character will blink. Then press the "OK" button will activate (deactivate) the ECO function.
- * In the cool mode, the variable frequency air-conditioner will enter the ECO function, which consumes the least electricity, and after 8 hours will exit it automatically.
- * The ECO function is not available on the fixed frequency air conditioner.
- * Changing modes or turning off the air conditioner will cancel the ECO function automatically.

- Note:** The electricity consumption is affected by the ambient temperature and the house structure etc., and when the ambient temperature is high or the house has a large area, be cautious to use the ECO function.

11. SLEEP function

- * When the unit is on, press the "MENU" button, then press Δ(+), ∇(-), ◀(L/R SWING) and ▶(U/D SWING) to choose the "SLEEP" character, and the "SLEEP" character will blink. Then press the "OK" button to activate (deactivate) the sleep function.
- * The unit will exit function after 10 hours of continuous operation and restore to the previous status.

- Note:** The sleep function cannot be activated in fan or auto mode.

12. DISPLAY function

- * Press the "MENU" button, then press Δ(+), ∇(-), ◀(L/R SWING) and ▶(U/D SWING) to choose the "DISPLAY" character, and the "DISPLAY" character will blink. Then press the "OK" button to activate (deactivate) the function of screen display.

13. ICLEAN function

- * The unit will clean automatically the dust on the evaporator and dry or blow-dry the moisture.
- * When the air-conditioner is off, press the "MENU" button, then press Δ(+), ∇(-), ◀(L/R SWING) and ▶(U/D SWING) to choose the "ICLEAN" character, and the "ICLEAN" character will blink. Then press the "OK" button to activate (deactivate) the function of cleaning.
- * The cleaning function will close automatically after 30 minutes.
- * During the cleaning function, if the "ON/OFF" button is pressed, the unit will be turned on immediately.

14. HEALTH function

- * When the unit is on or the unit is off but the timer is on, press the "MENU" button, then press Δ(+), ∇(-), ◀(L/R SWING) and ▶(U/D SWING) to choose "HEALTH" character, and the "HEALTH" character will blink. Then press the "OK" button to activate (deactivate) the health function.

- Note:** The HEALTH function will be cancelled automatically after the air conditioner is turned off.

15. ELE.H function

- * When the unit is on and in the HEAT mode, press the "MENU" button, then press Δ(+), ∇(-), ◀(L/R SWING) and ▶(U/D SWING) to choose the "ELE.H" character, and the "ELE.H" character will blink. Then press the "OK" button to activate (deactivate) the function of auxiliary heating.
- * The unit will activate the auxiliary heating function automatically according to the ambient temperature, so as to accelerate the heating.

16. ANTI-F function

- * The ANTI-F function: continue to operate for about 3 minutes to dry the moisture on the evaporator, so as to prevent the accumulation of bacteria on the evaporator, which causes fungus and strange smell and is harmful to the health.
- * When the unit is off, press the "MENU" button, then press Δ(+), ∇(-), ◀(L/R SWING) and ▶(U/D SWING) to choose the "Anti-F" character, and the "Anti-F" character will blink. Then press the "OK" button to activate (deactivate) the Anti-F function.

17. I-FEEL function

- * When the unit is on, press the "MENU" button, then press Δ(+), ∇(-), ◀(L/R SWING) and ▶(U/D SWING) to choose the "I-FEEL" character, and the "I-FEEL" character will blink. Then press the "OK" button to activate (deactivate) the I-FEEL function and the screen displays (disappears) the "⌚" icon.
- * After setting the I-FEEL function, the temperature area displays the touch temperature, which is refreshed every 5 seconds.
- * Press the "OFF" button will cancel the I-FEEL function and the "⌚" icon.

18. °C/°F function

- * The temperature is displayed by default in Celsius.
- * Press the "+" and "-" buttons at the same time above 3 seconds, you can set the "°C" or "°F".

19. Child-lock function

- * Press the "SPEED" and "SOFT" buttons at the same time and hold for at least 3 seconds to activate or deactivate the child-lock function.
- * When the child-lock function is activated, the remote control will indicate "🔒" icon.

20. 8°C heating function

- * Only in the heating mode and in the power-on state, press the "MODE" and "+" buttons at the same time above 3 seconds to turn on or off the 8°C heating function.
- * After turning on the 8°C heating function:
 - Press the "HEAT" button, or switch to mode, or select the sleep function, all can exit 8°C heating function.
 - Press any of the "SPEED", "+", "-" button is non-effective.
 - Turn off and on the unit again, 8°C heating function is still retained.
 - Press the "MENU" button, ELE.H function is not selectable.

21. Temperature setting function

- * When the unit is off, press the "MODE" and "SOFT" buttons at the same time above 10 seconds to enter the maximum and minimum temperature setting function:
- * The maximum and minimum temperature range is 16°C (60°F) ~ 32°C(90°F).
- * After entering this function, the screen will display the maximum setting value (32°C/90°F), and the "H" will flash, you can press the "+" or "-" button to adjust the maximum temperature range, then press the "Mode" button confirm. And now the screen is displaying the minimum temperature setting value, then the "L" will flash, you can press the "+" or "-" button to adjust the minimum temperature range, and press "Mode" to confirm, then the setting is complete;
- * When setting the minimum temperature, press the "MODE" and "SOFT" buttons at the same time above 10 seconds will switch to the maximum temperature;
- * You need to reset it after replacing the battery.

22. Buzzer silence function

- * Press the "L/R SWING" and "MODE" buttons at the same time and hold for 3 seconds to activate or deactivate the buzzer silence function.

23. Power Limit function

- * When the unit is on and in the cool or heat mode, press and hold the "Mode" button for 5 seconds to enter the power limit function. The temperature area will display and flash the "C1" character, if no operation is confirmed automatically after 5 seconds.
- * After entering this function, press the "Mode" button only to adjust this function, and the mode cannot be switched. The switch type of the power limit function is "C1-C2-C3-set temperature (without limiting power)". After each adjustment of the power limit function, the Cx (Cx is C1/C2/C3) character flashes continuously for 5 seconds and then is confirmed automatically.
- * Under the power limit function, the functions of "I-FEEL", "ECO" and "8°C heating" are invalid;
- * When the set temperature is adjusted, the set temperature is displayed constantly for 5 seconds and then the display of Cx is restored (Cx is C1/C2/C3).
- * Turn off the unit and switch the mode to exit the power limit function.

Usage for Mode

★ Auto operation mode

1. Press the “ON/OFF” button, the air-conditioner starts to operate.
2. Press the “MODE” button, select auto operation mode.
3. By pressing the “SPEED” button, you can select fan speed from Silence, Low, Mid-Low, Mid, Mid-High, High, Auto.
4. Press the “ON/OFF” button again, the air-conditioner stops.

Note: In the auto mode, the temperature setting is non-effective.

★ Cool/Heat operation mode

1. Press the “ON/OFF” button, the air-conditioner starts to operate.
2. Press the “MODE” button, select cool or heat operation mode.
3. By pressing the “+” or “-” button, you can set temperature from 16°C (60°F) to 32°C (90°F), the display will be changed as you press the button.
4. By pressing the “SPEED” button, you can select fan speed from Silence, Low, Mid-Low, Mid, Mid-High, High, Turbo, Auto.
5. Press the “ON/OFF” button again, the air-conditioner stops.

Note: The cold wind type has no heating function.

★ Dry operation mode

1. Press the “ON/OFF” button, the air-conditioner starts to operate.
2. Press the “MODE” button, select dry operation mode.
3. By pressing the “+” or “-” button, you can set temperature from 16°C (60°F) to 32°C (90°F), the display changes as you press the button.
4. Press the “ON/OFF” button again, the air-conditioner stops.

Note: In the dry mode, the speed setting is non-effective.

★ Fan operation mode

1. Press the “ON/OFF” button, the air-conditioner starts to operate.
2. Press the “MODE” button, select fan operation mode.
3. By pressing the “SPEED” button, you can select fan speed from Silence, Low, Mid-Low, Mid, Mid-High, High, Tubro.
4. Press the “ON/OFF” button again, the air-conditioner will stop.

Note: In the fan mode, the temperature setting is non-effective.

Usage

★ Fix batteries

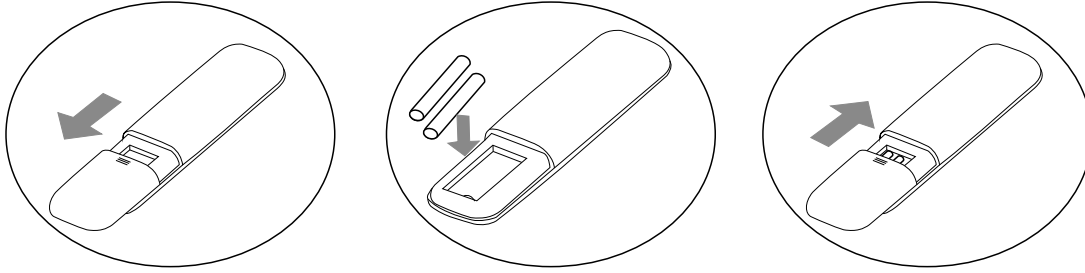

1. Slide to open the battery cover according to the direction indicated by the arrowhead.
2. Insert two brand new batteries (7#), and position the batteries to the right electric poles (+ & -).
3. Put back the battery cover.